

HEAD JAMB

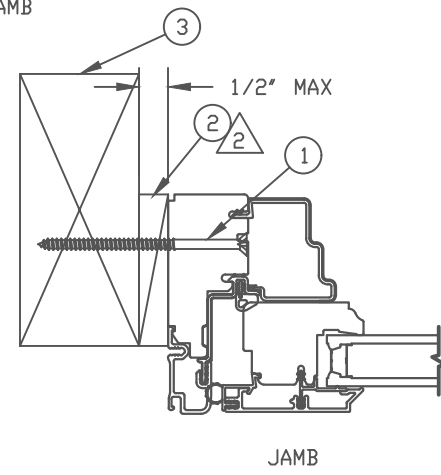

JAMB

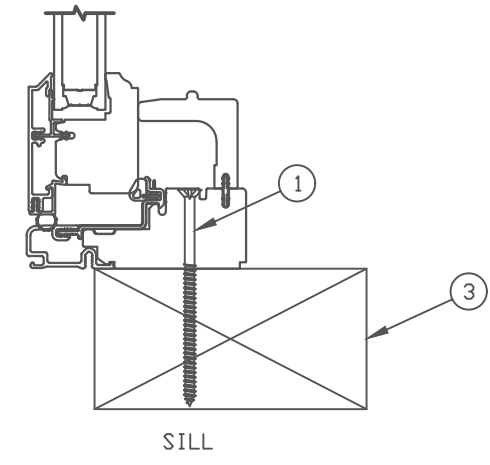

SILL

NARROW FRAME PRODUCT DETAILS

JAMB SCREW INSTALLATION

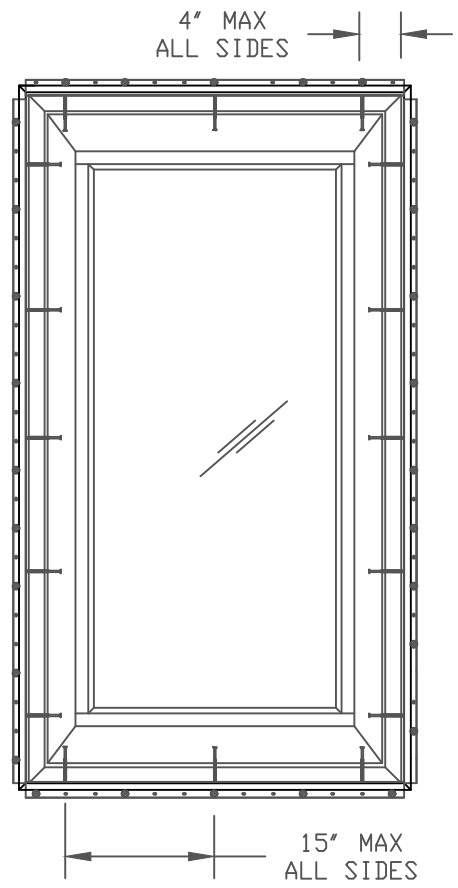

- JAMB SCREW INSTALLATION METHOD:
- UNIT MUST NOT BE IN DIRECT CONTACT WITH EITHER CONCRETE OR TREATED BUCK MATERIAL. IF SHIM SPACE IS LESS THAN 1/8" WRAPPING THE UNIT ON ALL 4 SIDES WITH WINDOW FLASHING TAPE IS REQUIRED AS A BARRIER BETWEEN THE UNIT AND CONCRETE OR TREATED LUMBER.
  - MINIMUM OF 2 PER SIDE.
  - SECURE ALL SIDES WITH #8 X 3" SCREWS.
  - SHIM AT EACH SCREW LOCATION.
  - ALTERNATE SUBSTRATES ALSO APPLY PROVIDED SCREW SIZE IS EQUAL TO OR LARGER THAN A #8 SCREW.
  - FOR DIRECT MOUNT TO CONCRETE 3/16" CONCRETE SCREWS MAY BE SUBSTITUTED FOR THE # 8 SCREWS; THE SCREW MUST BE FULLY SUPPORTED BY SHIM MATERIAL AND HAVE A MINIMUM EDGE DISTANCE OF 2" AND MINIMUM PENETRATION OF 1 1/4". MAXIMUM SHIM SPACE BETWEEN CONCRETE AND UNIT IS 3/4".

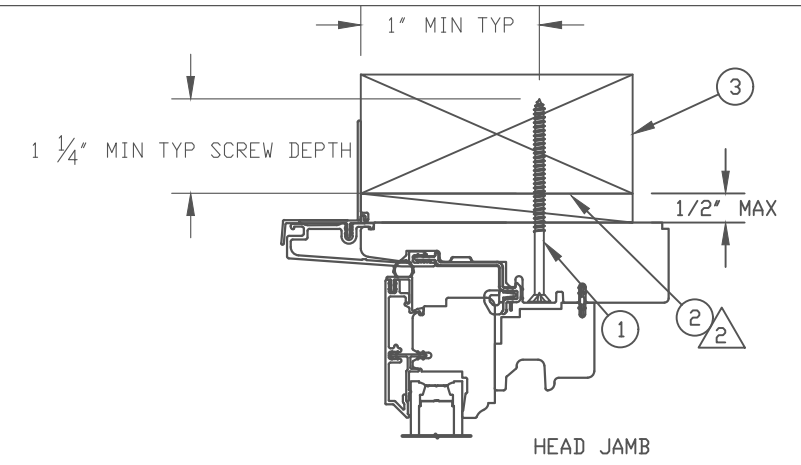

HEAD JAMB

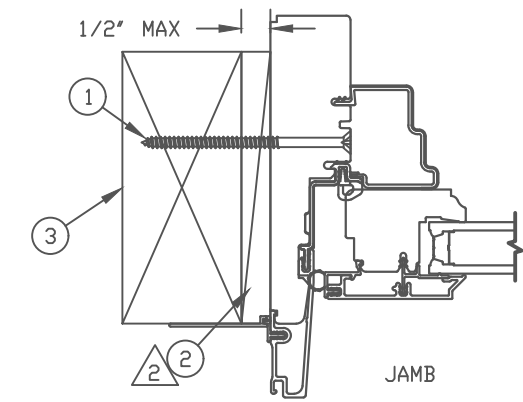

JAMB

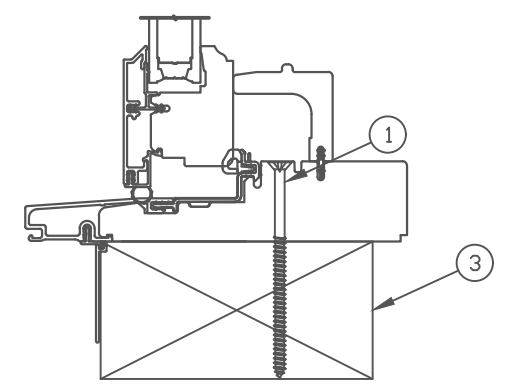

SILL

FULL FRAME PRODUCT DETAILS

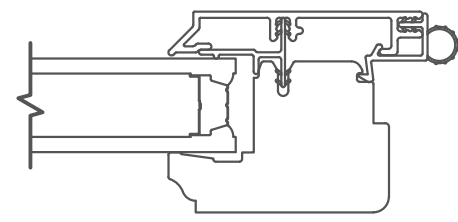

GLASS COMPLIES WITH ASTM E1300  
GLASS DETAIL

- NOTES FOR ALL METHODS:
- THIS PRINT IS FOR STRUCTURAL PERFORMANCE ONLY. FOR FLASHING & SEALING INSTRUCTIONS, REFER TO THE INSTALLATION INSTRUCTIONS.
  - SHIMS  
-PLACE A SHIM WITHIN 4-6 INCHES OF EACH CORNER AND SPACE ALL OTHERS EVENLY A MAXIMUM OF 15" APART.
  - IF CHEMICALLY TREATED LUMBER IS USED FOR BUCK MATERIAL, FASTENERS INTO THE BUCK MUST BE A MINIMUM OF 0.90 OZ/FT<sup>2</sup> ZINC HOT DIPPED GALVANIZED OR STAINLESS STEEL TYPE 304 OR 316.

UNIT	MAX FRAME SIZE	DP RATING
UL CSMNT	36 X 96 1/8	+50/-50
UL CSMNT NF	36 X 96 1/8	+50/-50
ULCSMNT	40 X 91 1/8	+50/-50
UL CSMNT NF	40 X 91 1/8	+50/-50

3	-----	WOOD BUCK BY OTHER
2	-----	SHIM
1	-----	#8 X 3.000 WOOD SCREW
ITEM NO	REF NO	DESCRIPTION

UNSPECIFIED TOLERANCES	
DECIMALS: XX ± .012 XXX ± .03	ANGLE DEG: ± .5
LINEAL: + .125 - .000	FAB LINEAL: ± N/A
MATERIAL:	N/A

**MARVIN** RESEARCH & DEVELOPMENT

PRODUCT: ULTIMATE CASEMENT  
 CATEGORY: ULTIMATE CASEMENT  
 UNIT TYPE: UCANF, UCANFAWN, UCANFP, UCAWN, UCA, UCAP

DWG TYPE: INSTALLATION  
 DESCRIPTION: INSTALLATION

CHK:	SIZE: B	CLASS: MISC	DWG NO: 00054235
APP:	SCALE: NA	DATE: 02/14/08	DWG BY: SOPKOWIAK, JOHN
			SHEET: 1 OF 1

NOTICE - CONFIDENTIAL INFORMATION

The information in this document is privileged and strictly confidential. The information contained herein shall be used only by Marvin Windows and Doors employees and by those agents or suppliers granted official written permission. If the reader of this document is not the intended recipient, or the employee or agent of the intended recipient, please delete this document from all data storage devices, and destroy all hard copies. Any unauthorized dissemination, distribution, copying or other use of the information contained in this document is strictly prohibited.